



DRC-006 USER GUIDE



COPYRIGHT

Copyright @ VP.Start Technology Co.,Ltd. 2022. All rights reserved.

No part of this document may be reproduced or transmitted in any form or by any means without the prior written consent of VP.Start Technology Co.,Ltd.

Trademarks and Permissions.

 and other VP.Start trademarks are the property of VP.Start Technology Co.,Ltd.

All other trademarks and trade names mentioned in this document are the property of their respective holders.

VP.Start Technology Co.,Ltd. provides customers with comprehensive technical support and services. For any assistance, please feel free to contact our company headquarters.

VP.Start HQ

Address: #15, Street 604, Sangkat Boeung Kok 2, Khan Toul Kork,
Phnom Penh, 120408, Cambodia.

VP.Start Sen Sok Valley Campus

Address: #29, Street 1946, Sangkat Phnom Penh Thmey, Khan Sen Sok,
Phnom Penh, 120408, Cambodia.

- Phone: (+855) 23 888 167 / 86 666 677 / 98 555 589
- Website: www.vpstart.com
- Email: sale@vpstart.com/info@vpstart.com

COPYRIGHT

VP.Start Proprietary

Copyright @ VP.Start Technology Co.,Ltd.



CONTENTS

CONTENTS

INTRODUCTION	1
PRODUCT OVERVIEW	2
HARDWARE DIMENSIONS	3
SPECIFICATIONS & FEATURES	4
INSTALLATION INSTRUCTIONS	8
APP USER GUIDE	15
TROUBLESHOOTING	56
CONTACT US	59



INTRODUCTION

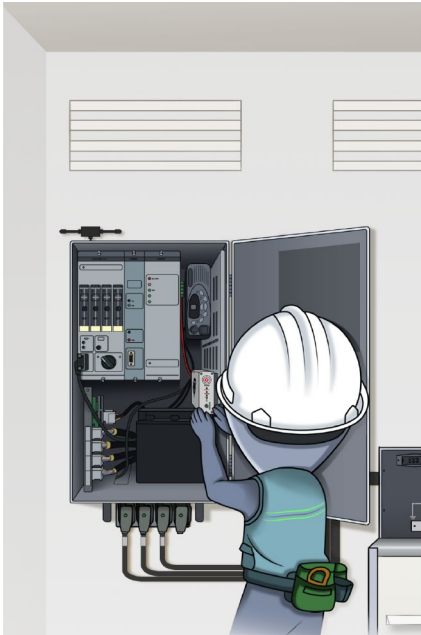

The DRC-006 is a smart controller for the Schneider Remote Terminal Unit (RTU Easergy T200i). This DRC-006 controller effectively supports operators due to its monitoring, alarm, report, and control capabilities over medium-voltage distribution network operation (22kV & 35kV). The DRC-006 can be managed and monitored via smartphone (Android) & RPM Grid (PC) applications securely over the GSM & GPRS networks, as well as standard call management for all of our DRCs. Operators using the DRC-006 stand to benefit from reduced power loss and better, faster management of power distribution systems to achieve greater user reliability. In addition, the enhanced capabilities through our DRC-006 "Smart-Controller" for the Schneider RTU T200i not only provide impressive results in increasing power reliability and reducing power loss on the network, but they also increase security for the maintenance team due to the remote control.

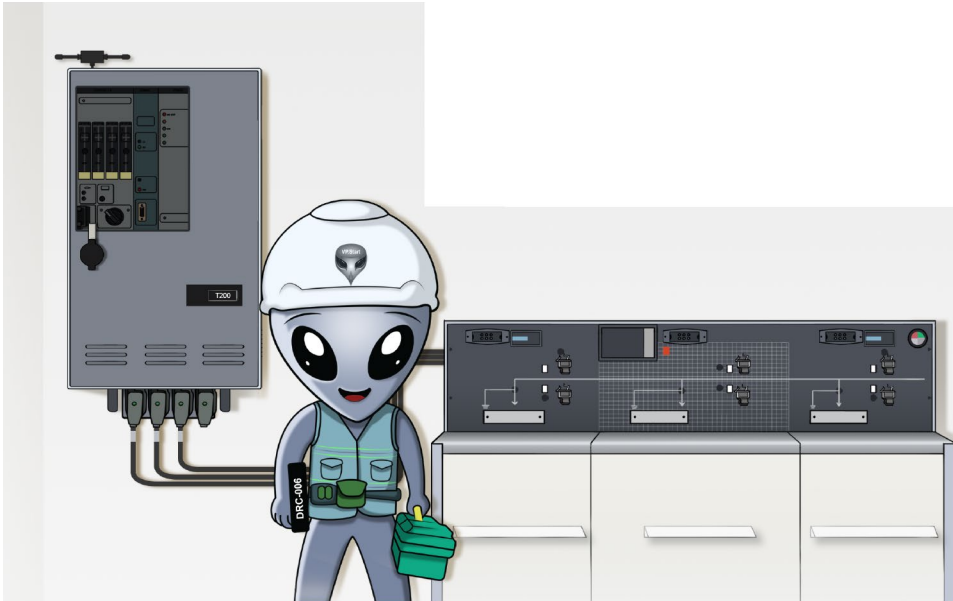

PRODUCT OVERVIEW



DRC-006 BOX PACKAGING

DRC-006 DEVICE



HARDWARE DIMENSIONS

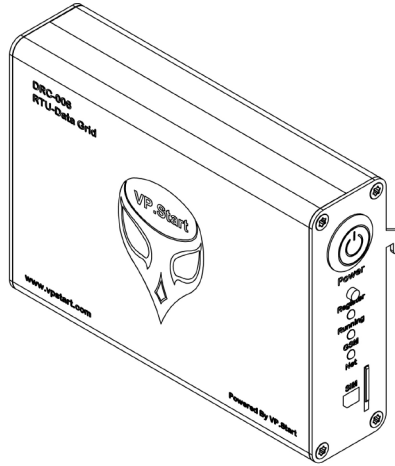

3D View

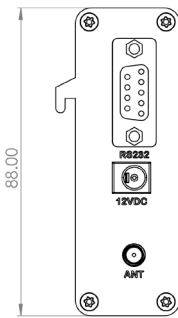

Side View

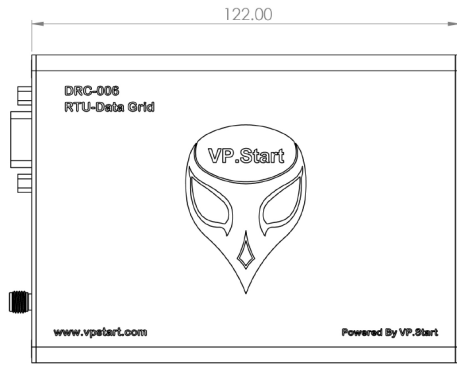

Front View

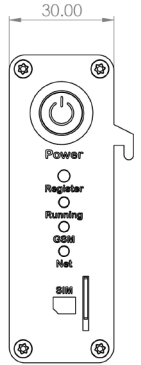

Side View



SPECIFICATIONS & FEATURES

Description

Specifications

Remote Control Unit

Remote Control for RTU (Schneider T200i)	Remote Controller via Smartphone for RTU (Schneider T200i) & can be configured to RPM Grid Software.
Supply Voltage Range	12 - 14 (Vdc)
Operation Temperature	0 to 65 °C
Ambient Temperature Range	-10 to +70 °C
Operating Humidity	30 to 95 (%)
Communication Interface	<ul style="list-style-type: none"> • Serial (RS232). • GSM Communication. • GPRS Communication.
Status LEDs	<ul style="list-style-type: none"> • System Running: Blinking 1s. • System Power: Red LED is ON. • System Network: Green LED Flashing.
App & Software Tools Interface	<ul style="list-style-type: none"> • PC application: RPM Grid Software Solution. • Mobile Application: DRC-006 Android App.

Remote Control Functions & Features

Control Functions:

Switchgear Control Ability	Capable to Remote Control up to 4 Units of Switchgear.
Switchgear Control	Remote Control OPEN/CLOSE

Monitoring Features:

Current Line	Yes
--------------	-----



Switchgear Position Status	OPEN/CLOSE/Ground
Feeder Status	Normal/On-Fault
Feeder Fault Indicator	Phase-Fault/Ground-Fault
Control Mode	Local/Remote
Switchgear MV Presence Monitor	Yes
RTU Time & Date	Yes
Battery Fault Status	Yes
AC Supply Status	Yes
GSM Signal Strength (1-30)	Yes
Controller Location on Map	Google Map View
Setting Features:	
Tracking Abilities	Controller ID, Name, Coordinate, Serial Number
RMU Switchgears Profile Configuration	(Enable/Disable SWs in the DRC-006 App/ RPM Grid).
MV Absence Alarm	Enable/Disable
AC Source Supply OFF Alarm	Enable/Disable
Feeder Fault Alarm	Enable/Disable
Internet Data Reporting Access	Enable/Disable



Data Upload Timer	OFF/15mins/30mins/60mins
Software Management:	
Controller's User Management	Add / Remove user View all users
User Level/Position	Admin/User
Controller Balance	Check/Top-up via Special Dialing Code.
Controller Management	Add / Remove controller Name / Rename controller Add / Remove controller's profile picture View all controllers.
Alarm Notifications:	
Switchgear MV Absence Alarm	Yes
AC Source Supply OFF Alarm	Yes
Switchgear OFF Alarm	Yes
Feeder Ground Fault Alarm	Yes
Feeder Phase Fault Alarm	Yes
Reporting & Event log:	
User Switchgear Control Event Logs	Yes
RTU Event Logs	Yes
Call Control Functions	
Key Tone Control Features:	

Read Switchgear Position	OPEN/CLOSE/Ground/Switch not Connect
Call Control Switchgear	Control Switchgear OPEN/CLOSE
Feeder Current Measurement	Read Feeder Current Measurement (Amp)
Language & Voice Support:	
Language	Khmer
Call Control Instruction Sound Track	Yes
Physical Specification & Installation:	
Controller Dimension	H=88mm x L=122mm x W=30mm
Controller Weight	200mg
Mounting & Installation	The Remote Control (DRC-006) is connected & mounted inside the RTU T200i Cabinet.



INSTALLATION INSTRUCTIONS

ACCESSORIES



DRC-006 Controller (1pc)

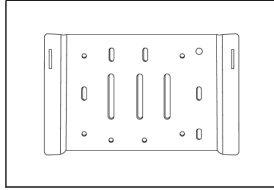

Controller Support (1pc)

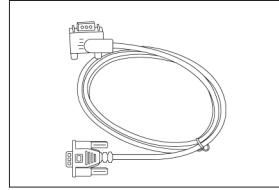

Serial Cable (Female to Female) (1pc)

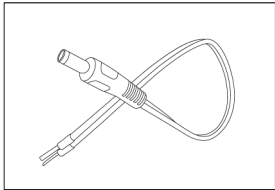

DC Power Cable (1pc)

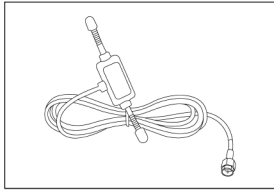

GSM Antenna (1pc)

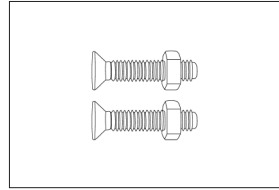

Screw + Nut (M4*15cm) (2pcs)

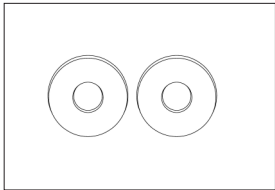

Flat Washer (2pcs)

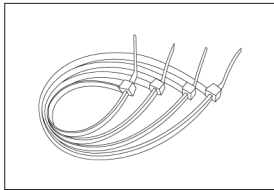

Cable Tie (6pcs)



SUPPORTING TOOLS

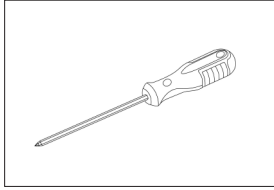

Screwdriver PH2

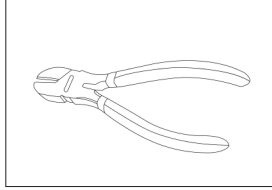

Diagonal Cutting Pliers

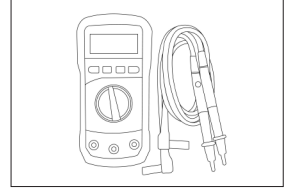

Multimeter



CONTROLLER INSTALLATION PROCESS

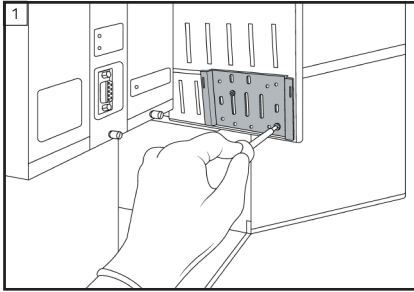

Mount the controller support on RTU T200i Controller Support Panel.

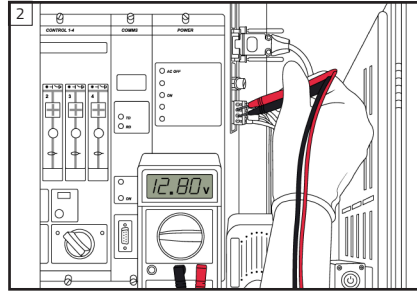

By RTU T200i DC Supply Connector, check the voltage through 12V (+) and 12V (-).

NOTE

The suitable voltage shall be 12VDC to 14VDC.

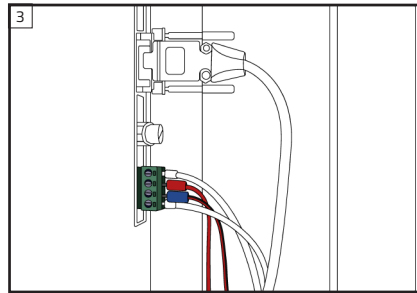

Connect DC Power Cable by the Red Cable to 12V (+) and Black Cable to 12V (-).

INSTALLATION INSTRUCTIONS

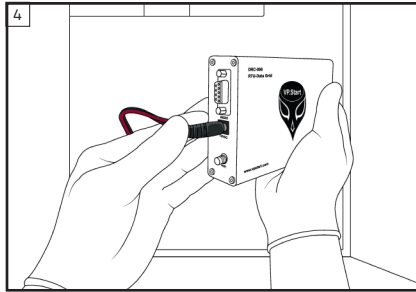

Then connect to the 12VDC port on DRC-006 Controller.

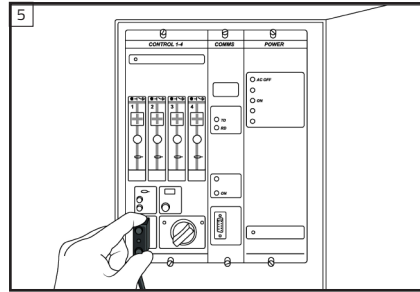

Connect Serial Cable to RS232 port on RTU T200i Controller.

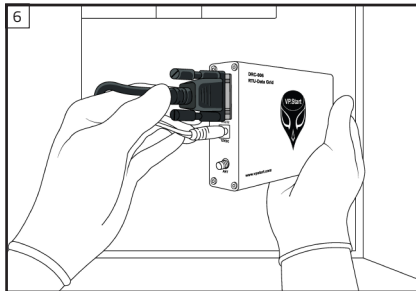

Connect Serial Cable to RS232 port on DRC-006 Controller.

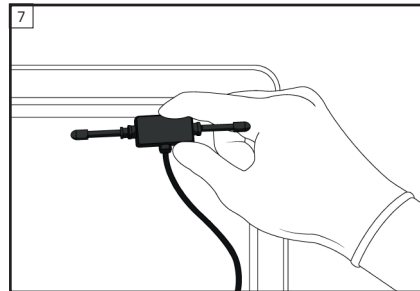

Install GSM Antenna to the appropriate area on site.



NOTE

The area that allows the antenna to get better signal strength.

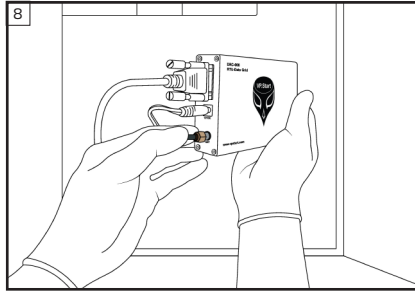

Then connect to the ANT port on the DRC-006 controller.

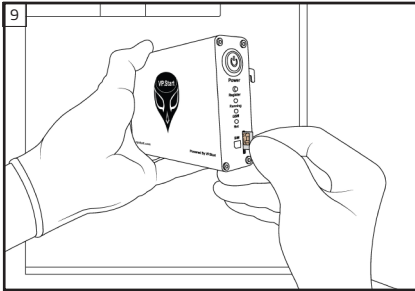

Insert SIM (micro) into SIM Slot on DRC-006.

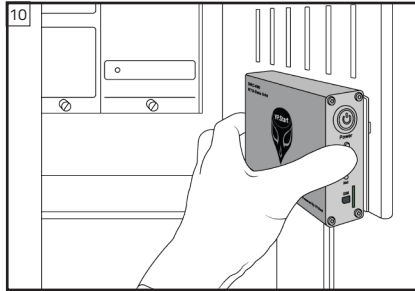

Mount the DRC-006 on the controller support.



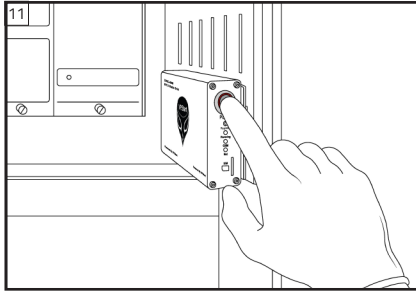

To start up the DRC-006, by pushing the Power button.

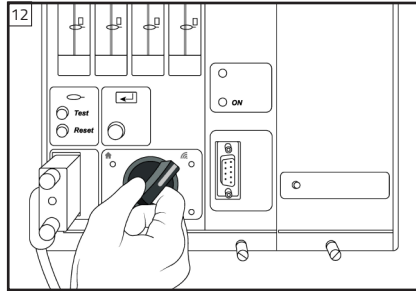

DRC-006 works on both Local/Remote mode.

NOTE

- ❖ The DRC-006 is running normally if the running LED is blinking every 1s.
- ❖ The GSM connection is Good if Net LED flashing every 3s.
- ❖ The GSM Module is Okay if GSM LED is ON.

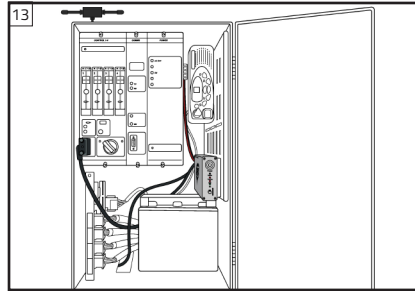

DRC-006 installed with RTU T200i Controller.



APP USER GUIDE

Mobile Phone Interface Usage

01

How to Install DRC-006 App on Smartphone

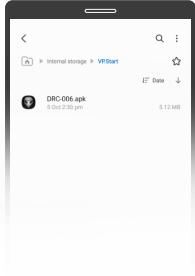

Fig | 01

Click on "DRC-006 .apk" to install.

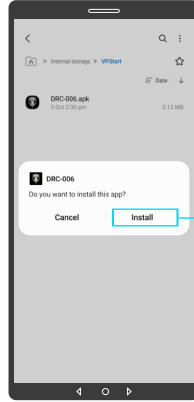

Fig | 02

Click on "Install".

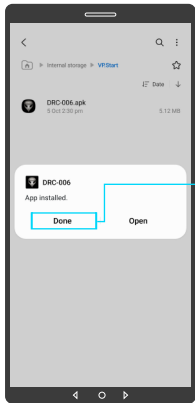

Fig | 03

Click on "Done" to finish.



Fig | 04

DRC-006 App installed.



02 Create User Account



Fig | 05

Click on "DRC-006 App" to open App.

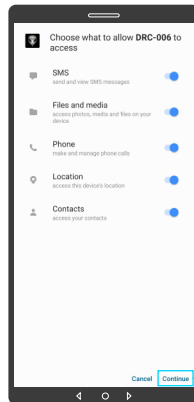

Fig | 06

If the system pop up allow DRC-006 to access.

Then click on "Continue".



Fig | 07

Create User Account login interface.

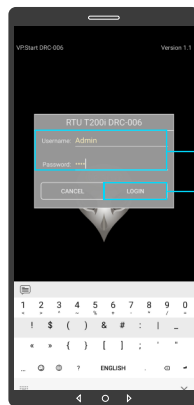

Fig | 08

Create: Username and Password.

Then click on "LOGIN".



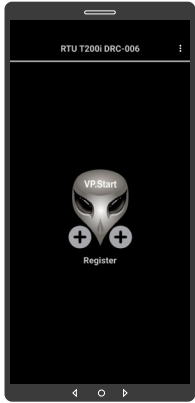

Fig | 09

NOTE

When installing the DRC-006 smartphone application for the first time, users will have to register the first DRC-006 controller before they can access other functions.

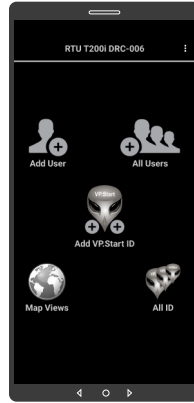

Fig | 10

NOTE

After the first controller is registered, users can access other functionalities as showed in Fig. 10.

03 Login to App



Fig | 11

Click on "DRC-006 App" to open App.

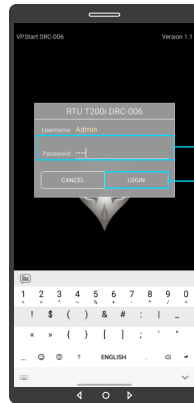

Fig | 12

Input the Password.

Click on "LOGIN".



Fig 13

DRC-006 App functions.

04 Service

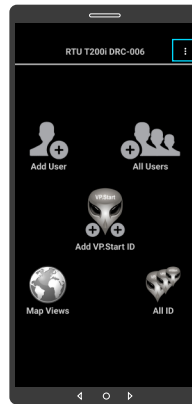

Fig 14

Click here to view "Help, Service and Exit".

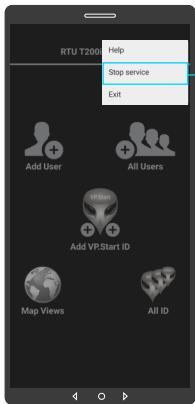

Fig 15

After the device(s) has been registered. Alarm service is enabled by default. To stop it, click on Stop service to stop receiving automated alarms from the controller through the smartphone app.



Fig 16

Alarm service is not running when your smartphone has not enabled DRC-006 alarm service as shown in Fig. 16.

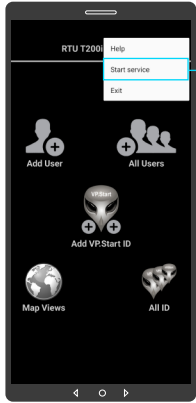

Fig | 17

To start alarm service. Click to view "Help, Service and Exit".
 Click on "Start service" to start receiving automated alarms from the controller through the smartphone app.

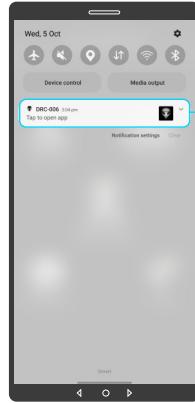

Fig | 18

Alarm service is running when your smartphone has enabled DRC-006 alarm service as shown in Fig.18.

05 Adding Users

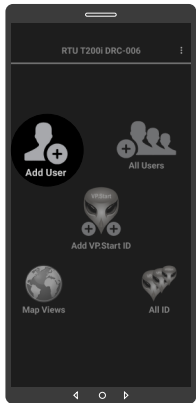

Fig | 19

Click to open "Add User".

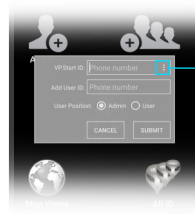

Fig | 20

Click here to view all VP.Start ID (Phone Number).

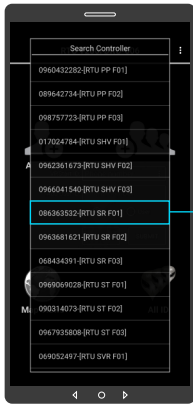

Fig 21

Click to choose a VP.Start ID.

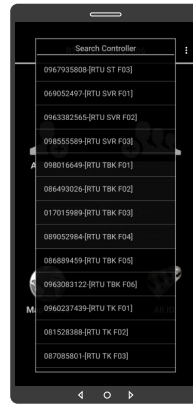

Fig 22

NOTE
 Scroll up or down to view more VP.Start ID.



Fig 23

VP.Start ID chosen.



Fig 24

Write user phone number in "Add User ID".
 Choose user position as Admin or User.
 Click on "SUBMIT" and confirm by "OK" button.



Fig | 25

NOTE

☑ The application will display "Done" as a pop up notification to confirm the registration of the new user into the system for a specific controller.

06 All Users

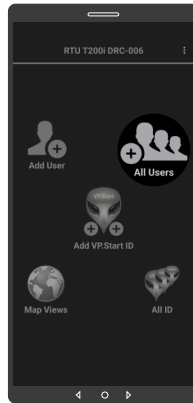

Fig | 26

Click to open "All Users".



Fig | 27

Click here to view all VP.Start ID (Phone Number).

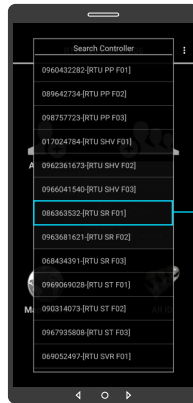

Fig | 28

Choose a VP.Start ID.



Fig | 29

Confirm "OK" button.



Fig | 30

Click on Refresh button. And confirm by "OK" button.

07

Delete User



Fig | 31

All Users view.

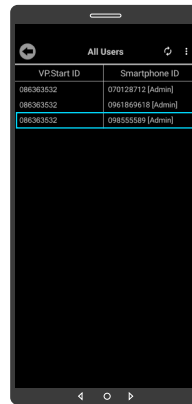
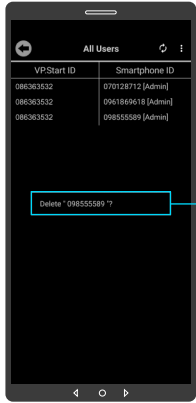

Fig | 32

To delete user from your DRC-006, hold on user number.



Click on Delete "User phone number" and confirm by "OK" button.

Fig | 33



User deleted.

Fig | 34

Add VP.Start ID

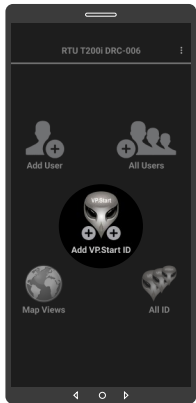

Click to open "Add VP.Start ID".

Fig | 35

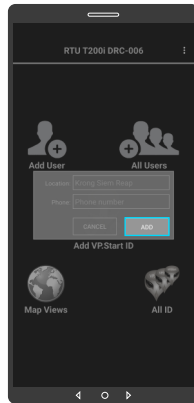

Add VP.Start ID interface.

Fig | 36

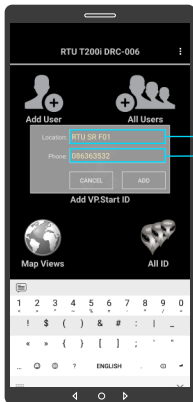

Fig | 37

Click to write location name (DRC-006 name).

Click to write VP.Start ID (DRC-006 phone number).

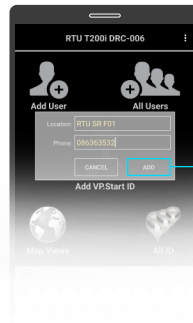

Fig | 38

Click on "ADD" button and confirm by "OK" button.

09 Map Views

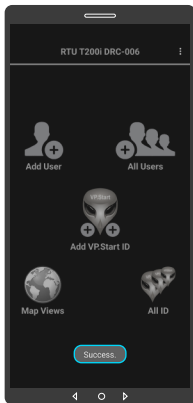

Fig | 39

NOTE

The application will display "Success" as a pop up notification to confirm the registration of the DRC-006 controller into the system.

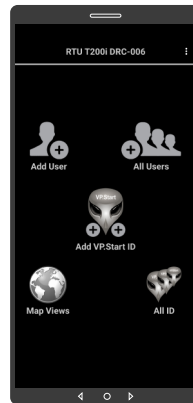
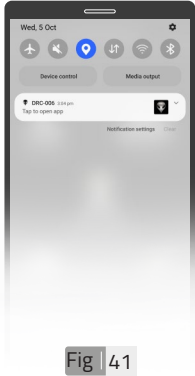

Fig | 40

Scroll down notification bar.





Turn on location.

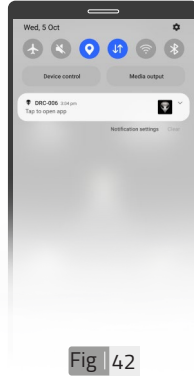

Turn on Internet.

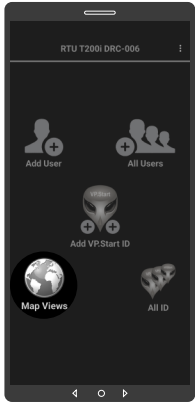

Click to open "Map Views".

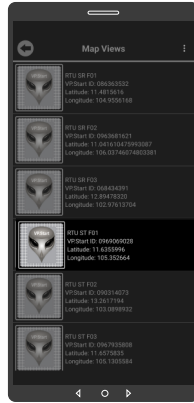

Select a VP.Start ID.

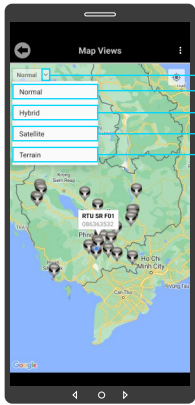

Fig 45

Click here to chose map views.

View Normal map.

View Hybrid map.

View Satellite map.

View Terrain map.

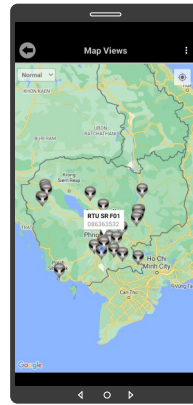

Fig 46

Normal view

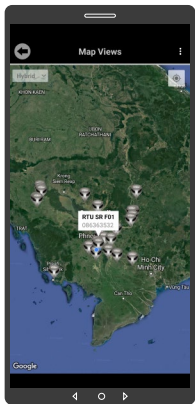

Fig 47

Hybrid view

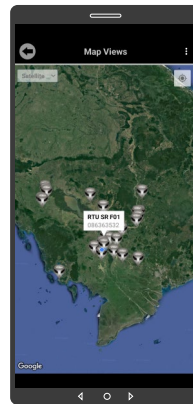

Fig 48

Satellite view

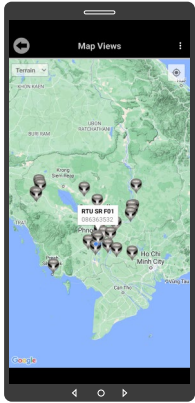

Fig 49

Terrain view

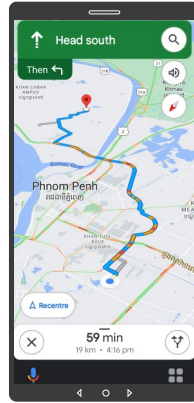

Fig 50

Hold on VP.Start icon to show Drive Mode to VP.Start controller on Google Map.

10 Map Views (Change Map Coordinates)

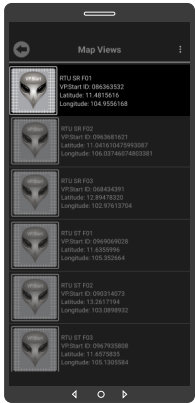

Fig 51

To change map coordinate, hold on VP.Start ID in "Map Views".

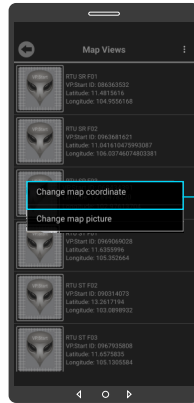
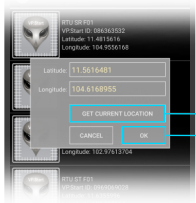

Fig 52

Click on "Change map coordinates".



Click on "GET CURRENT LOCATION".

Click on "OK" button.

Fig 53

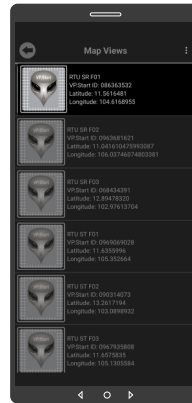

DRC-006 location changed.

Fig 54

11 Map Views (Change Map Picture)

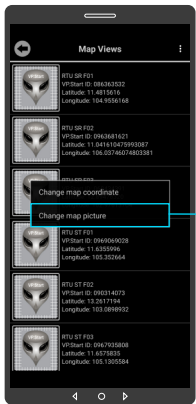

To change map picture, click and hold VP.Start ID in "Map Views" as Fig. 51. And click on "Change map picture".

Fig 55

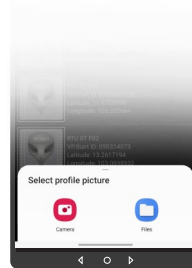

Take photo from "Camera" or choose photo from "File" and select photo. And confirm by "OK" button.

Fig 56



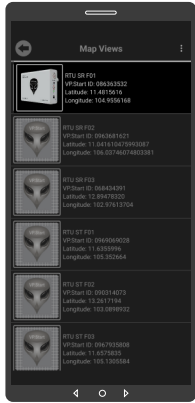

Fig 57

DRC-006 map picture changed.

12 Map Views (Delete Map Picture)

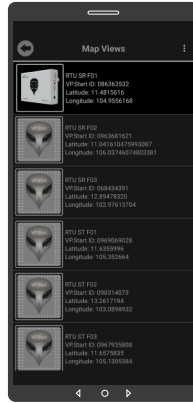

Fig 58

To Delete Map Picture, hold on map picture.

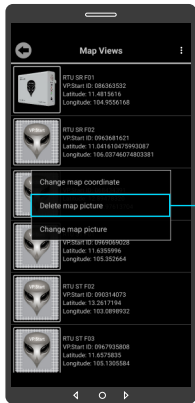

Fig 59

Click on "Delete map picture" and confirm by "OK" button.

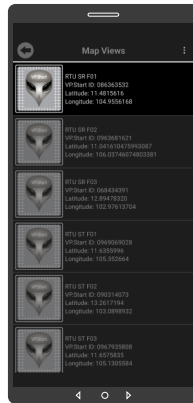

Fig 60

Map picture deleted.



13 All IDs

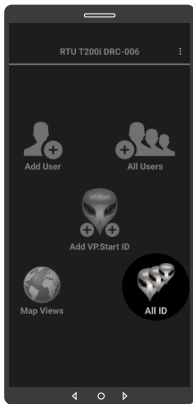

Fig 61

Click on "All ID".



Fig 62

All VP.Start ID view.

14 Control Interface



Fig 63

NOTE
 Scroll up or down to view more VP.Start ID.

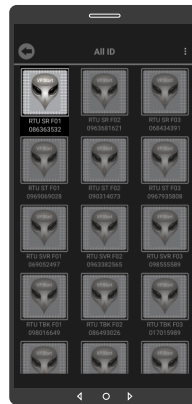

Fig 64

Select a VP.Start ID.

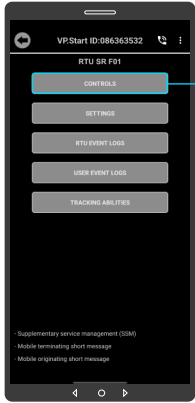

Fig | 65

Click on "CONTROLS".



Fig | 66

Click on "OK" button.



Fig | 67

Control Interface.

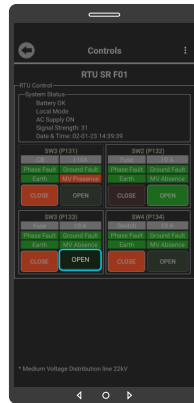

Fig | 68

To control "Open Switchgear", click on "Open" button.



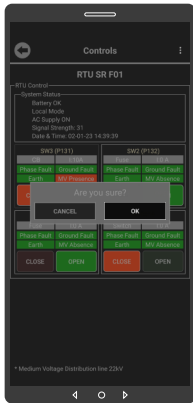

Fig 69

Click on "OK" button.

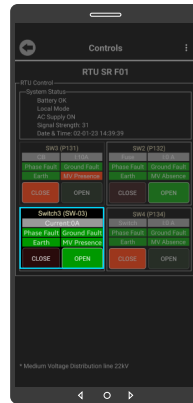

Fig 70

Control "Open Switchgear" success.



Fig 71

To control "Close Switchgear", click on "Close" button.

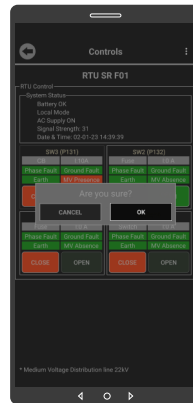

Fig 72

Click on "OK" button.

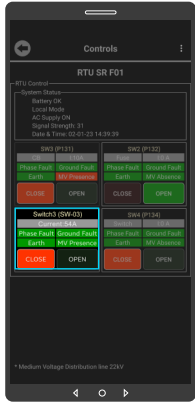

Fig 73

Control "Close Switchgear" success.

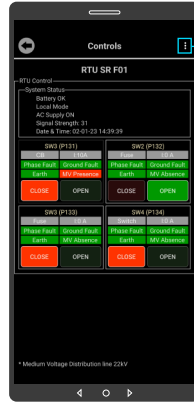

Fig 74

To label Switchgear, click on "Menu Sign".

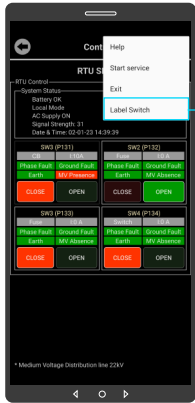

Fig 75

Click on "Label Switch".

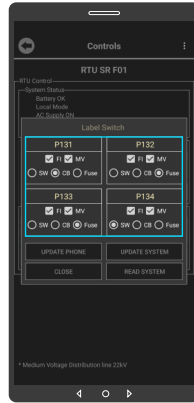

Fig 76

Label the Switchgear. Add "✓" on which Switchgear connect with Fault Indicator (FI), MV Present (MV) and select RMU type as Switchgear, Circuit Breaker or Fuse.





Fig 77

- Click to update data to phone.
- Click to update data from phone to system.
- Click to read data from system to phone.
- Click to exit.



Fig 78

Click on "OK" button.

15 Settings Interface



Fig 79

Label Switch data updated.

NOTE

"Success" will pop up as a notification message below indicating that the controller has been successfully set. Current Warning value in the system.



Fig 80

Click on "SETTINGS".



Fig | 81

Click on "OK" button.



Fig | 82

Settings Interface.



Fig | 83

To turn AC Supply OFF alarm off, click on "AC Supply OFF Alarm (ON)" button.

NOTE
 Internet Report for configuration to RPM Grid system.

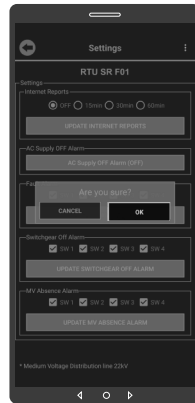

Fig | 84

Click on "OK" button.



Fig 85

AC Supply OFF Alarm turn off success.

NOTE

"Success" will pop up as a notification message below indicating that the controller has been successfully turn off Source Alarm in the system.

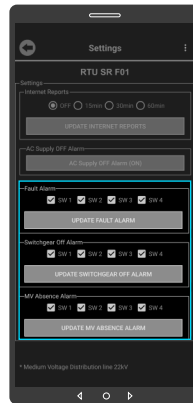

Fig 86

To update Fault Alarm, Switchgear Off Alarm and MV Absence alarm, add "✓" on "SW" of the Switchgear, click on "UPDATE" button and confirm by "OK" button.

16 RTU Event Logs Interface



Fig 87

Alarm configured.

NOTE

"Success" will pop up as a notification message below indicating that the controller has been successfully update alarm configuration in the system.

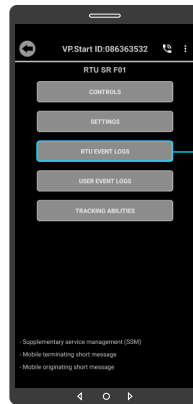

Fig 88

Click on "RTU EVENT LOGS".





Fig | 89

Click on "Refresh" button to read RTU Event Logs.

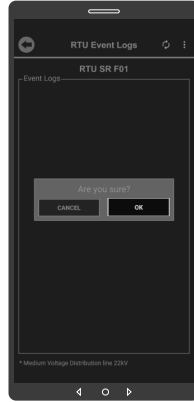

Fig | 90

Click on "OK" button.

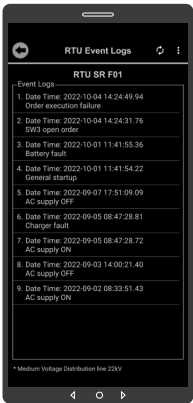

Fig | 91

RTU Event Logs Interface.



Fig | 92

Click on "Refresh" button to get more RTU Event Logs.

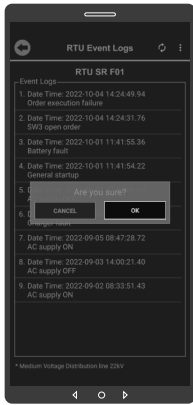

Fig 93

Confirm by "OK" button.



Fig 94

More RTU Event Logs.



Fig 95

NOTE
 Scroll up or down to view more RTU Even Logs.

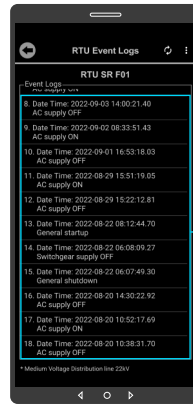

Fig 96

To delete RTU Event Logs, hold on RTU Event Logs.

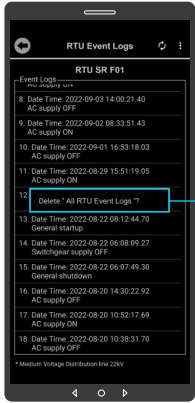

Fig | 97

Click on "Delete All RTU Event Logs", and click on "OK" button.



Fig | 98

RTU Event Logs deleted from App interface.

17 User Event Logs Interface

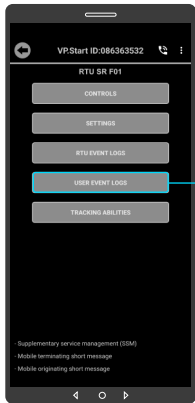

Fig | 99

Click on "USER EVENT LOGS".



Fig | 100

Click on "Refresh" button to read User Event Logs. Confirm by "OK" button.

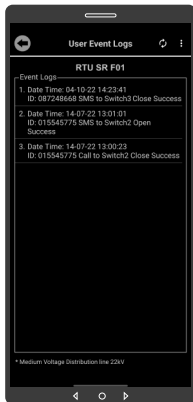

Fig 101

User Event Logs Interface.

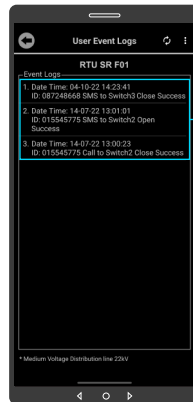

Fig 102

To delete User Event Logs, hold on User Event Logs.

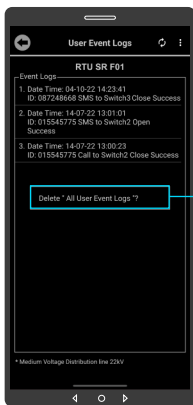

Fig 103

Click on "Delete All User Event Logs", and click on "OK" button.

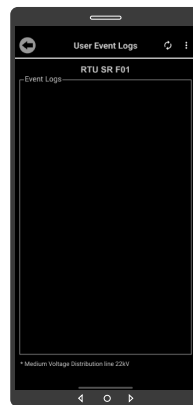

Fig 104

User Event Logs deleted from App interface.

18 Tracking Abilities Interface

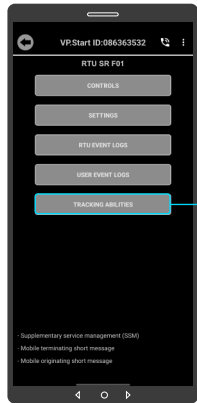

Fig 105

TRACKING ABILITIES

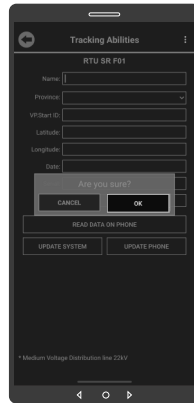

Fig 106

Confirm by "OK" button.

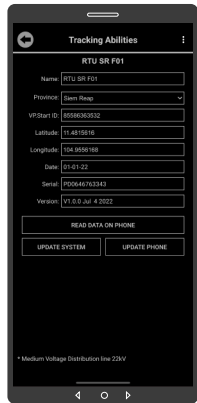

Fig 107

Tracking Abilities Interface.

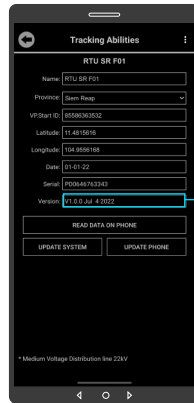

Fig 108

To update controller Firmware, hold on "Controller Version".



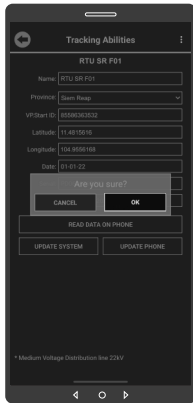

Fig | 109

Confirm by "OK" button.

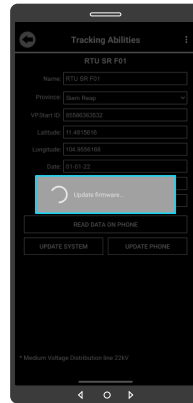

Fig | 110

Update Firmware process.

19 Remote "Call Control"

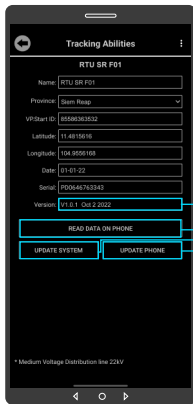

Fig | 111

- Firmware update success.
- Click to read data on phone.
- Click to update data from phone to system.
- Click to update date to phone.

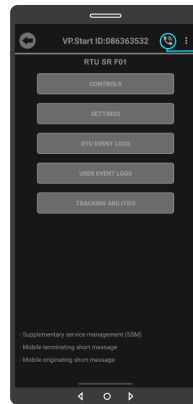

Fig | 112

Click on "Call" button to initiate call control.

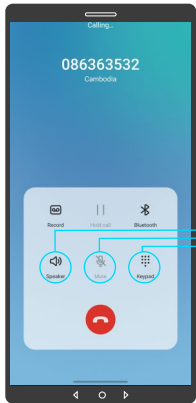

Fig 113

- Click to turn on Speaker.
- Click to Mute.
- Click to show Keypad.

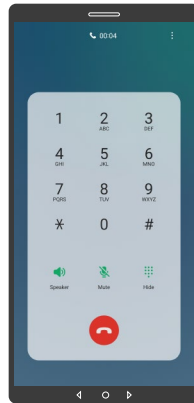

Fig 114

Remote call control interface.

CALL CONTROL

- Click on ① for control "1st Switchgear".
- Click on ② for control "2nd Switchgear".
- Click on ③ for control "3rd Switchgear".
- Click on ④ for control "4th Switchgear".
- Click on ⑤ for opening "Control Mode".
- Click on * for "Open".
- Click on # for "Close".
- Click on ⑨ for "Re-start Controller".

② Renaming VP.Start IDs (DRC-006 Controllers)

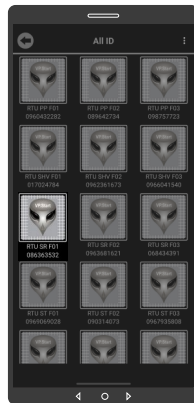

Fig 115

To rename VP. Start ID click and hold on VP.Start ID icon.

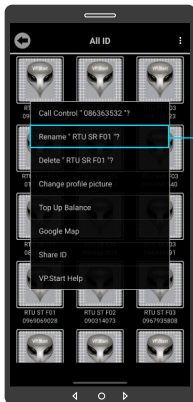

Fig | 116

Click on "Rename".

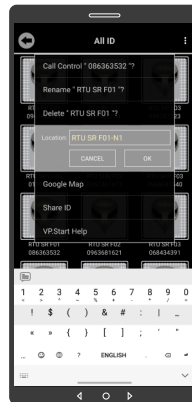

Fig | 117

Rename existing name. And click on "OK" button.

21 Delete VP.Start ID

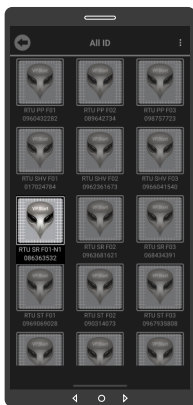

Fig | 118

Controller's name changed.

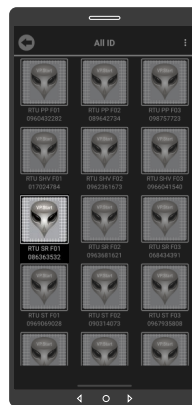

Fig | 119

To delete VP.Start ID, hold on VP.Start ID icon.



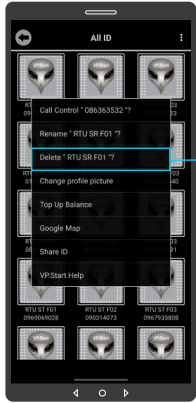

Fig 120

Click on "Delete".
Then click on "OK"
button.

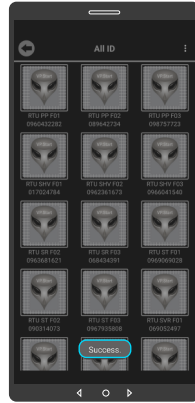

Fig 121

NOTE

"Success" will pop up as a notification message below indicating that the controller has been successfully deleted from the system.

22 Clear Alarm



Fig 122

To Clear Alarm, hold on alarmed VP.Start ID.

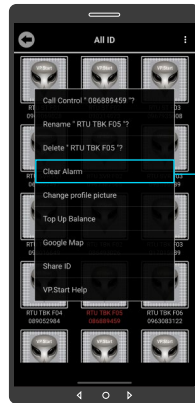

Fig 123

Click on "Clear Alarm".
Click on "Back" sign.



Fig | 124

Alarm VP.Start ID cleared.

23 Change Profile Picture

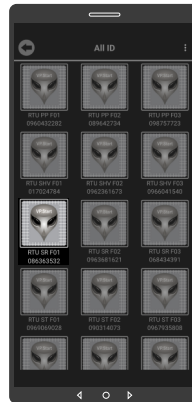

Fig | 125

To change profile picture, hold on VP.Start ID icon.

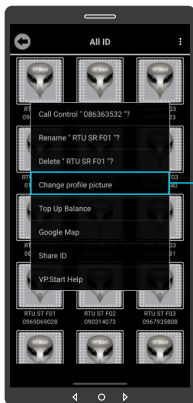

Fig | 126

Click on "Change profile picture"

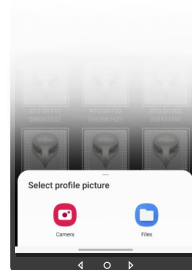

Fig | 127

Take photo from "Camera" or choose photo from "File" and select photo. And confirm by "OK" button.





Fig 128

Profile picture changed.

24

Delete Profile Picture

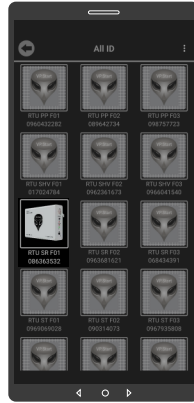

Fig 129

To Delete profile picture, hold on VP.Start ID icon.

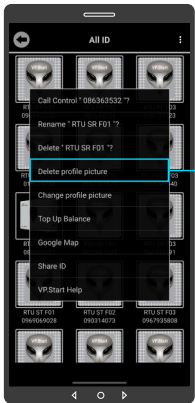

Fig 130

Click on "Delete profile picture". And confirm by "OK" button.

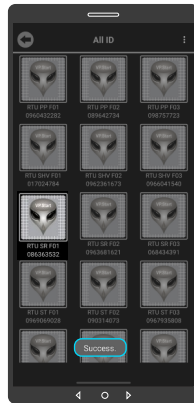

Fig 131

Controller profile picture deleted.

NOTE
 "Success" will pop up as a notification message below indicating that the controller has been successfully deleted from the system.



25 Top Up/Check Balance

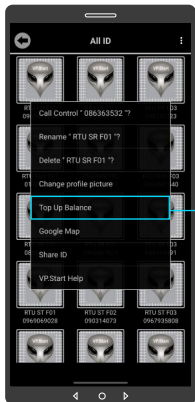

Fig | 132

To top up or check balance, hold on VP.Start ID icon and click on "Balance".

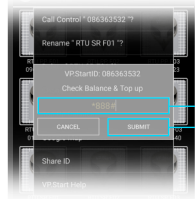

Fig | 133

Input the top up or check balance command.
Click on "SUBMIT" to send the "Check or top up balance" command to the controller.



Fig | 134

Confirm by "OK" button.

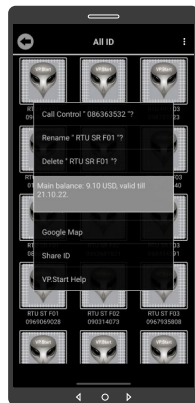

Fig | 135

Balance interface showed.

26 Google Map

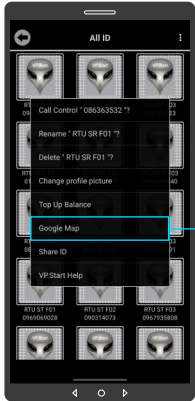

Fig 136

To view Google Map with Drive Mode to VP.Start controller, Click on "Google Map".

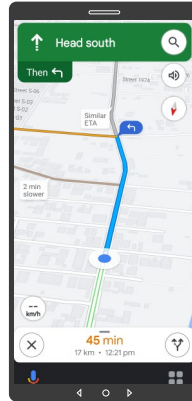

Fig 137

Google Map Drive Mode showed.

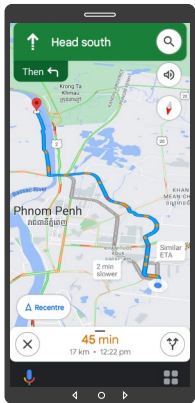

Fig 138

Click on "X" sign to view in Google Map view.

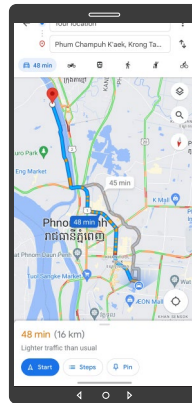

Fig 139

Google Map viewed.



27 Share ID

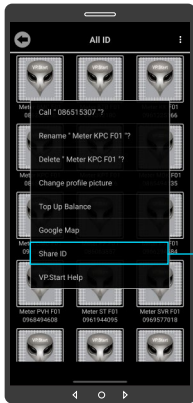

Fig | 140

To share VP.Start ID to other phone, hold on VP.Start ID icon and click on "Share ID".

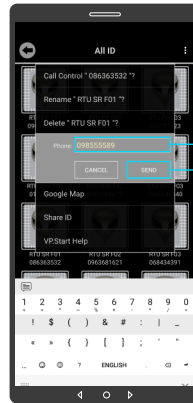

Fig | 141

Click to write phone number to share.
Click on "SEND" button.

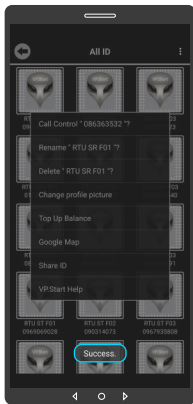

Fig | 142

NOTE
"Success" will pop up as a notification message below indicating that you have successfully shared the DRC-006 controller's ID and controller information to another phone as shown in Fig. 142.

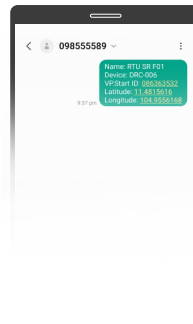

Fig | 143

NOTE
Controller ID and information displayed as an SMS with a shared number.



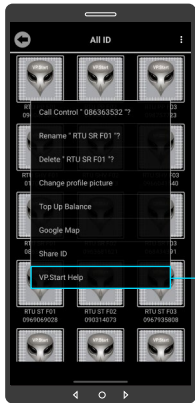

Fig 144

To alert to call center immediately for help, click and hold on VP.Start ID icon and Click on "VP.Start Help".

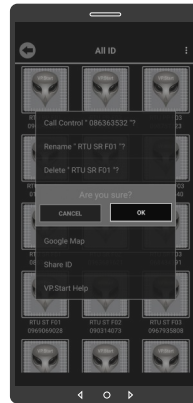

Fig 145

Click on "OK" button. The app will command the DRC-006 controller to automatically share its ID information and call directly to VP.Start's call center to alert our support team immediately.

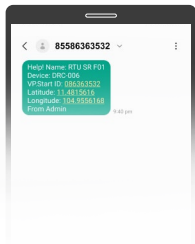

Fig 146

NOTE
As shown in Fig. 146, the DRC-006 controller will share its ID to VP.Start's call center

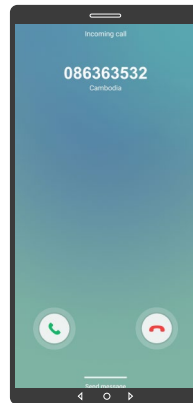

Fig 147

NOTE
As shown in Fig. 147, the DRC-006 controller is calling VP.Start's call center to immediately alert the support team.

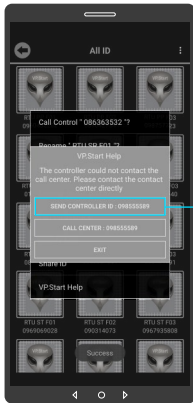

Fig | 148

If the controller is inaccessible for any reason, the app can be used to manually send the controller ID to the VP.Start call center. Click on "SEND CONTROLLER ID: 09855589" to execute the Command. And confirm by "OK" button.

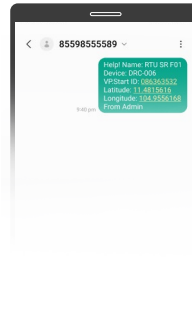

Fig | 149

NOTE

The user has shared the controller's ID manually with VP. Start's call center as shown in Fig. 149.

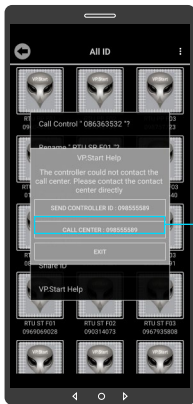

Fig | 150

Or Click on "CALL CENTER: 09855589" to call to VP. Start's call center.

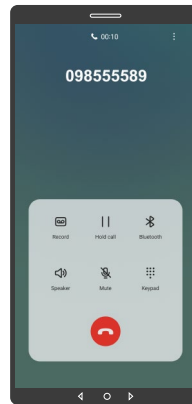

Fig | 151

NOTE

User has manually executed the command to call VP. Start's call center.

28 Alarm System



Fig 152

Switchgear OFF Alarm.

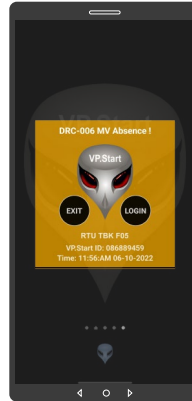

Fig 153

MV Absence Alarm.

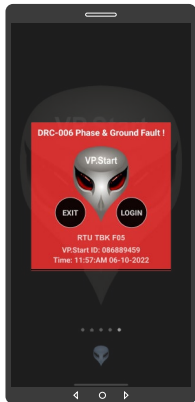

Fig 154

Phase & Ground Fault Alarm.



Fig 155

Phase Fault Alarm.

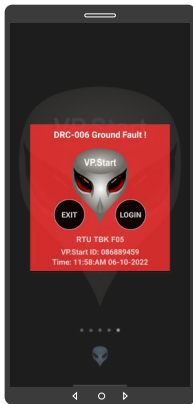

Fig | 156

Ground Fault Alarm.



Fig | 157

AC Supply off Alarm.



Fig | 158

NOTE

⚠ An alarm notification message will appear whenever the system detects a problem such as Switchgear OFF, MV Absence, Phase & Ground Fault, Phase Fault, Ground Fault and AC Supply OFF.

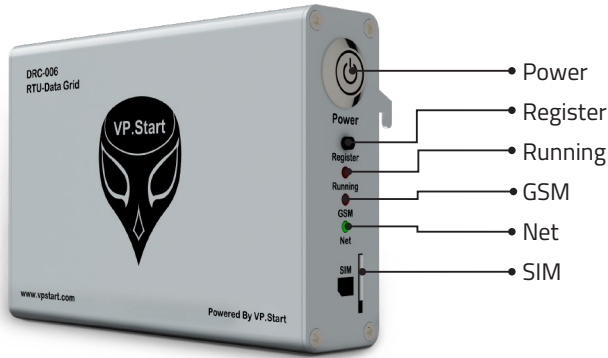

Fig | 159

NOTE

- 📍 Click on "LOGIN" to login controls interface panel.
- 📍 Click on "EXIT" to exit an alarm notification message.

TROUBLESHOOTING



LED Light Status Explanation

LED Light	LED Status	System Working Status
Power	Off	The Power button is not turned On. No power input.
	Red	Power On
Running	Red (blinking every 1s)	Running normally
GSM	Red On	GSM On
	Off	GSM Off
Net	64ms On/800ms Off	GSM has not registered to a network
	64ms On/3000ms Off	GSM has registered to a network
	64ms On/300ms Off	GPRS communication
	Off	GSM is not running



TROUBLESHOOTING

Test Serial DRC-006 Controller

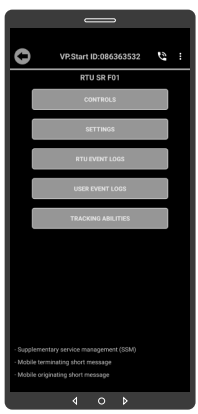

Fig 01

To Test Serial DRC-006 Controller, click on "Menu Option" sign.

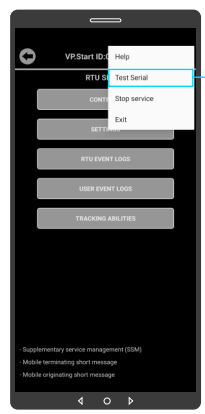

Fig 02

Click on "Test Serial".



Fig 03

Connect pin 2 to pin 3 on DRC-006 controller.

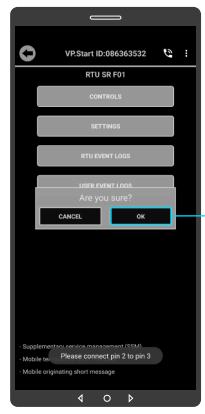

Fig 04

Click on "OK" button.

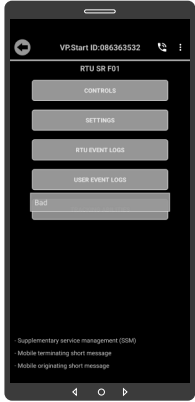

Fig | 06

Serial Error.

NOTE

The notification message "Bad" indicating that DRC-006 controller's Serial Error.

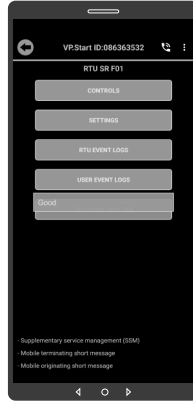

Fig | 07

Serial OK.

NOTE

The notification message "Good" indicating that DRC-006 controller's Serial ok.

CONTACT US



VP.Start



VP.Start HQ

#15, Street 604, Sangkat Boeung Kok 2,
Khan Toul Kork, Phnom Penh, 120408,
Cambodia.



VP.Start Sen Sok Valley Campus

#29, Street 1946, Sangkat Phnom Penh
Thmey, Khan Sen Sok, Phnom Penh,
120408, Cambodia.



(+855) 23 888 167 / 86 666 677 / 98 555 589



sale@vpstart.com/info@vpstart.com



www.vpstart.com



