



DRC-006

Installation Instruction



I. Introduction

The DRC-006 is a smart controller for the Schneider Remote Terminal Unit (RTU Easergy T200i). This DRC-006 controller effectively supports operators due to its monitoring, alarm, report, and control capabilities over medium-voltage distribution network operation (22kV & 35kV). The DRC-006 can be managed and monitored via smartphone (Android) & RPM Grid (PC) applications securely over the GSM & GPRS networks, as well as standard call management for all of our DRCs. Operators using the DRC-006 stand to benefit from reduced power loss and better, faster management of power distribution systems to achieve greater user reliability. In addition, the enhanced capabilities through our DRC-006 "Smart-Controller" for the Schneider RTU T200i not only provide impressive results in increasing power reliability and reducing power loss on the network, but they also increase security for the maintenance team due to the remote control.

II. Accessory

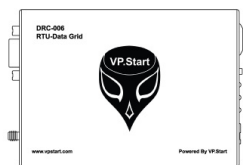

DRC-006 Controller
(1pc)

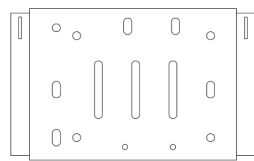

Controller Support
(1pc)

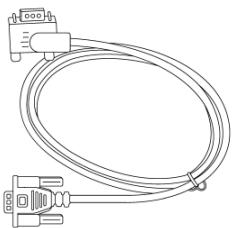

Serial Cable (Female to Female) (1pc)

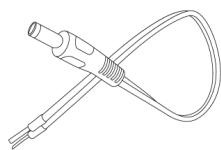

DC Power Cable (1pc)

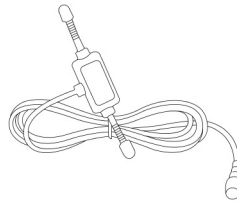

GSM Antenna
(1pc)

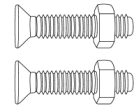

Screw + Nut
(M4*15cm) (2pcs)

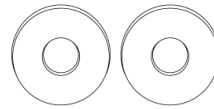

Flat Washer
(2pcs)

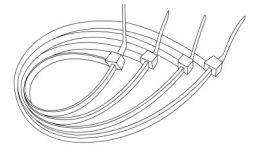

Cable Tie (6pcs)

III. Installation Procedure

Tools Support

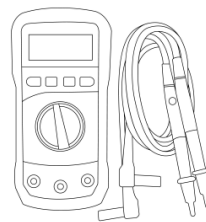

Multimeter

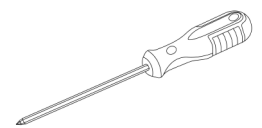

Screwdriver PH2

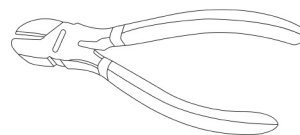

Diagonal Cutting Pliers

📍 Controller Installation Process

- 01** Mount the controller support on RTU T200i Controller Support Panel.

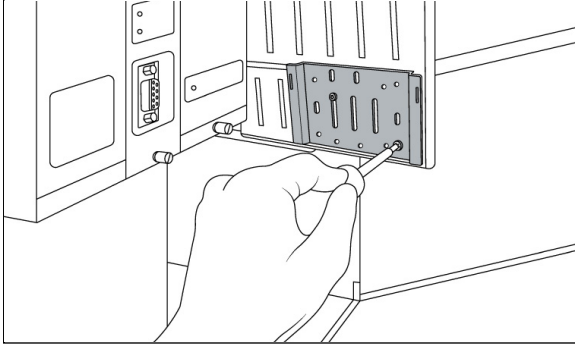

- 02** By RTU T200i DC Supply Connector, check the voltage through 12V (+) and 12V (-).

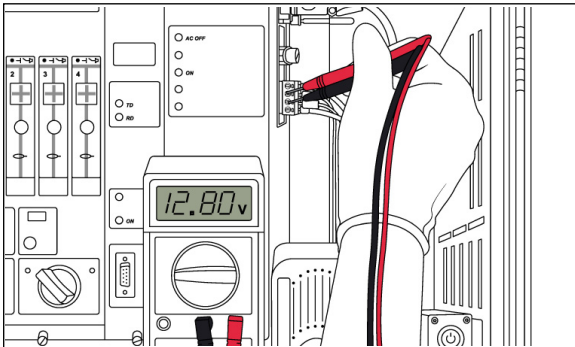

⚠️ NOTE

- 📍 The suitable voltage shall be 12VDC to 14VDC.

- 03** Connect DC Power Cable by the Red Cable to 12V (+) and Black Cable to 12V (-).

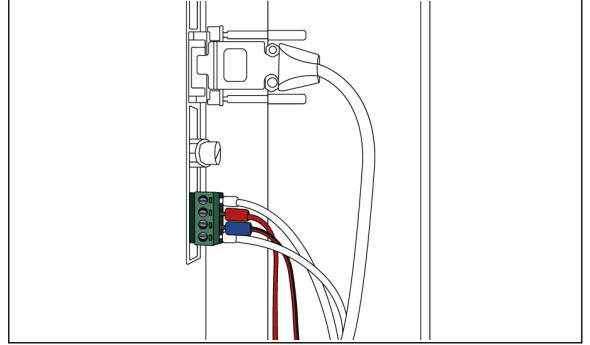

- 04** Then connect to the 12VDC port on DRC-006 Controller.

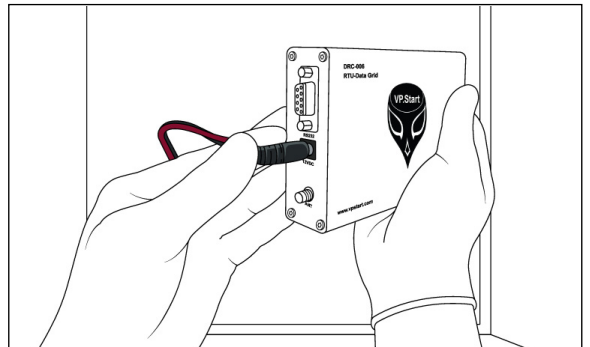

- 05** Connect Serial Cable to RS232 port on RTU T200i Controller.

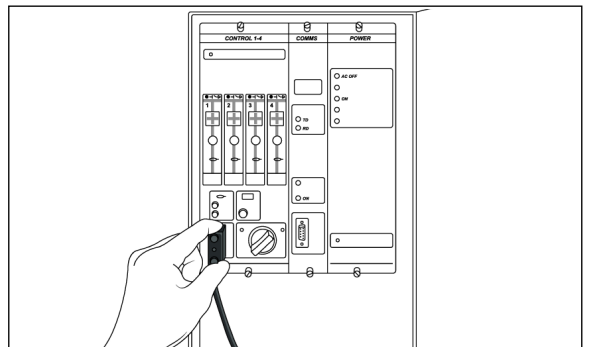

- 06** Connect Serial Cable to RS232 port on DRC-006 Controller.

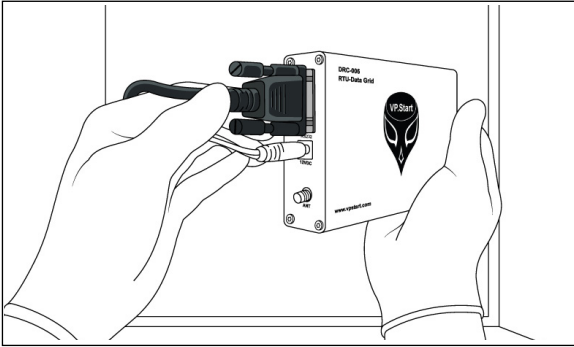

- 07** Install GSM Antenna to the appropriate area on site.

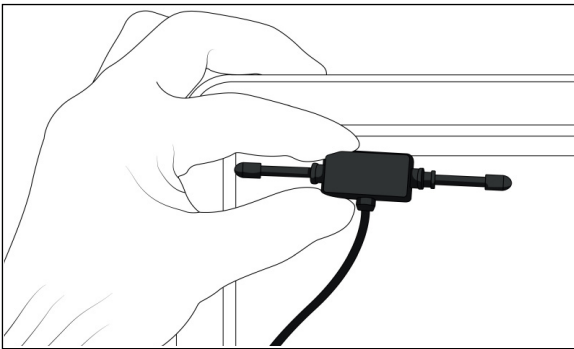

NOTE

- 📍 The area that allows the antenna to get better signal strength.

- 08** Then connect to the ANT port on the DRC-006 controller.

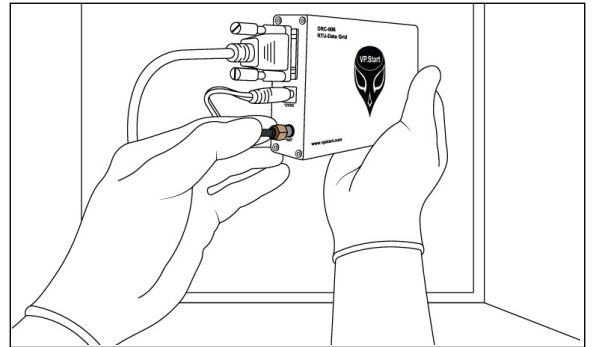

- 09** Insert SIM (micro) into SIM Slot on DRC-006.

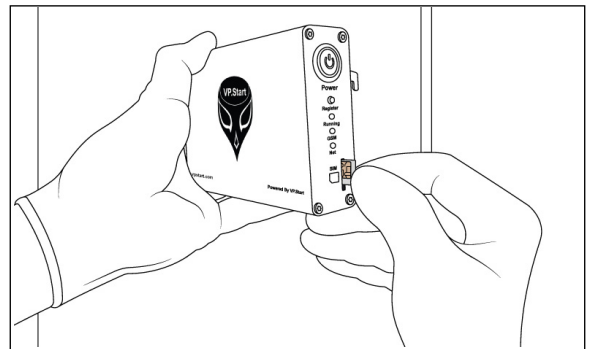

- 10** Mount the DRC-006 on the controller support.

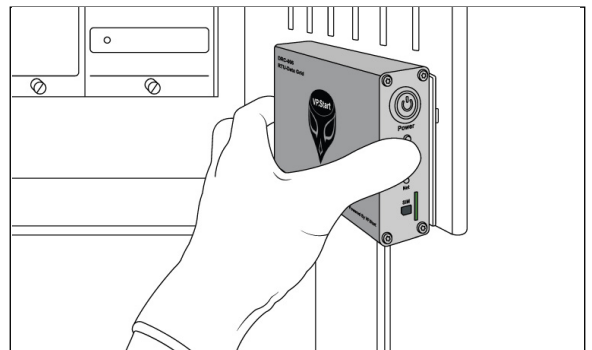

- 11 To start up the DRC-006, by pushing the Power button.

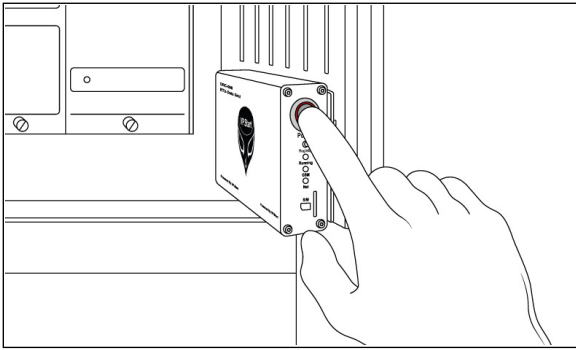

NOTE

- The DRC-006 is running normally if the running LED is blinking every 1s.
- The GSM connection is Good if Net LED flashing every 3s.
- The GSM Module is Okay if GSM LED is ON.

- 12 DRC-006 works on both Local/Remote mode.

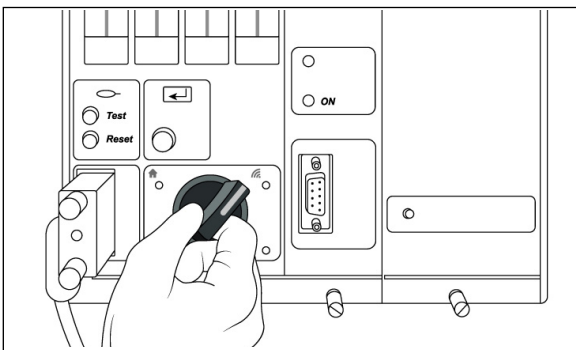

- 14 DRC-006 installed with RTU T200i Controller.

